



ZROADZ

DYNAMIC LED MOUNTING SOLUTIONS



PROFESSIONAL INSTALL RECOMMENDED

2017 FORD RAPTOR

PART#: Z335162

FRONT ROOF LED LIGHT MOUNTS

PARTS ARE PATENT PENDING. ALL RIGHTS RESERVED - COPYRIGHT ©2019 - ZROADZ LED, INC.

PARTS INCLUDED

- (1) - Driver Side Roof Mount Upright
- (1) - Passenger Side Roof Mount Upright
- (1) - Driver Side Straight Coupler
- (1) - Passenger Side Straight Coupler
- (1) - Hardware Pack



* Simulated Rendering, Not actual parts.

LED LIGHTS INCLUDED

Z335162 - No LED Lights Included

HARDWARE INCLUDED

Z335162

- (1) - Weather Proof Rubber Boot
- (1) - 3/16 DIA. Wire Clip Mount
- (2) - 1/2 x 20 Hex Nut
- (2) - 1/2 Split Lock Washer
- (8) - 10-32 x .562 Button Head Allen Cap Stainless Steel Screws
- (8) - 10/32 Nylock Stainless Steel Nuts
- (1) - Driver Side Bottom Plate Gasket
- (1) - Passenger Side Bottom Plate Gasket

TOOLS REQUIRED

- Tapered 1/2" drill bit or car reamer
- Drill
- Air Hose & Nozzle
- Alcohol Cleaning Solution
- Cleaning Rag
- Socket Set & Ratchet Tool
- Ratchet Extensions
- Various Wrenches
- Dikes or Snips
- Torq Bit Set
- Heat Gun

MATERIALS NEEDED

- Clear RTV Silicone
- 1/2" x 1/4" DIA Shrink Tube

INSTALLATION GUIDE

START HERE

PLEASE READ AND UNDERSTAND ALL INSTRUCTIONS BEFORE INSTALLATION. Auto makers offer varied models to each vehicle and occasionally manufacture more than one body style of the same model. To assure your part is correct; our tech department can be contacted at orders@zroadz.com to verify fitment and assist with technical questions. All other inquires can be directed to orders@zroadz.com. In the event you do not have internet access please call 844-653-8040

* APPLICATION MODELS VARY. WE RECOMMEND TO VERIFY FITMENT BEFORE BEGINNING INSTALLATION PROCESS.
* IMAGES FEATURED IN THE INSTRUCTION DOCUMENTS MAY NOT ALWAYS EXACTLY MATCH YOUR MODEL OR PART.

BEFORE YOU BEGIN

LED LIGHT BRACKET INSTALLATION

IMPORTANT NOTE: The installation requires additional cutting and removal of material inside vehicle cab. If you are not comfortable with this, stop installation and consult a professional.

START HERE: Turn off engine, chalk tires with stop block, open the hood and disconnect the battery.



FIG 1

STEP 1

1) Drop OEM headliner down to allow access to the inside of vehicle roof moulding, per industry "R&R" method.

STEP 2

SEE FIGURE 2

2) From above, If your vehicle has this feature, remove or push to the side roof seam moulding. (The Black Rubber Strip near both top edges of vehicle cab.)



FIG 2



ZROADZ

DYNAMIC LED MOUNTING SOLUTIONS

LED LIGHT BRACKET INSTALLATION - CONTINUED

PARTS ARE PATENT PENDING. ALL RIGHTS RESERVED - COPYRIGHT ©2016 - ZROADZ LED, INC.



FIG 3

STEP 3

3) Ford F-150 model vehicles feature an interior cab structure that will require meticulous fabrication to remove material and enable access to the through bolt after the cab hole has been drilled.

In Step #5 you will drill your hole, after this is completed, continue to carve out access inside the skeletal cavern.



FIG 4

STEP 4

SEE FIGURE 4

4) Obtain the supplied roof mount base gaskets to use as a template to locate the drill hole location. Lay the gasket in the roof channel.

DO NOT REMOVE THE GASKETS ADHESIVE LINER.



FIG 5

SEE FIGURE 5

Make sure to gasket is centered transversely (from right to left) in the channel. The front to back location of the gasket should be 1/4" from the top edge of the windshield glass to the end of the front of the gasket. See Figure #5 to reference how bracket is / should be positioned.

STEP 5

SEE FIGURES 6-7-8-9

5) Using the gasket hole as a locator, center punch the pilot hole location.

INSTALLERS NOTE

Drop and push to the side the air bags and any other critical equipment stuffed up in between roof cab and the interior which will ensure critical components are not damaged.

With the interior roof free and clear, drill a 1/4" hole in the roof gutter to pilot the mounting hole. Use a car reamer (as seen in Figure #7) or tapered 1/2" metal drill bit to open the hole to a final diameter of 1/2".

With the holes drilled through, clean off all drilling debris and flash INSIDE AND OUTSIDE OF THE DRILL HOLE LOCATIONS. This is a very important to create a flush sealing surface and you do not want to leave any chance of rust occurring.

DRILLING VEHICLE ROOF



FIG 6

PRO TIP

DO NOT ATTEMPT INSTALL UNLESS YOU HAVE A CAR REAMER OR TAPERED 1/2" METAL DRILL BIT!



FIG 7

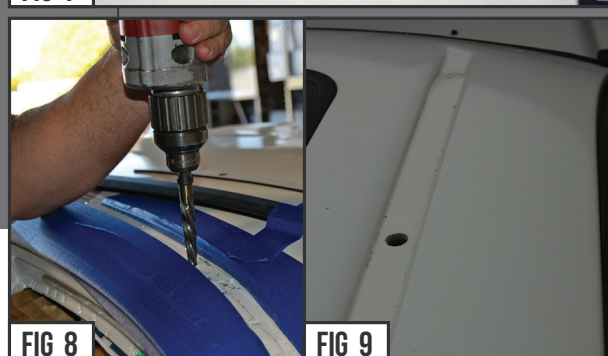

FIG 8

FIG 9

LED LIGHT ROOF MOUNT INSTALLATION - CONTINUED



ZROADZ

DYNAMIC LED MOUNTING SOLUTIONS

LED LIGHT BRACKET INSTALLATION - CONTINUED

PARTS ARE PATENT PENDING. ALL RIGHTS RESERVED - COPYRIGHT ©2016 - ZROADZ LED, INC.

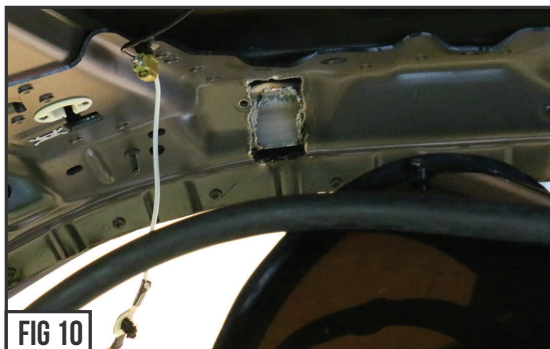

STEP 6

SEE FIGURE 10

6) Cut away and remove material from the interior vehicle cab structure to make room to install washer and nut onto the bottom side of bracket through bolt and down tube.

STEP 7

SEE FIGURE 13

7) Clean the base of the supplied roof brackets with alcohol. Once dry remove the liner of the base gaskets from step #4 and apply the gasket to the base of each bracket.



STEP 8

SEE FIGURE 14

8) Before you install the bracket to the roof, check that the threads on the post after coming through the roof are clean.

With the roof and channel area debris free and wiped down clean with alcohol cleaning solution.

Use a thin layer of clear RTV Silicone around outside of each drilled hole to help with weather proofing and sealing.

STEP 9

SEE FIGURE 15

9) Align the ZROADZ LED Mounting bracket to the roof and insert the through bolt threads down into the drilled hole.

Make sure the outside of the upright is coated black and says ZROADZ while the inside of upright presents the aluminum skin. Inspect your work to make sure you are happy with the position and then repeat for other side.

INSTALL ROOF MOUNT TO ROOF



LED LIGHT ROOF MOUNT INSTALLATION - CONTINUED



ZROADZ

DYNAMIC LED MOUNTING SOLUTIONS

LED LIGHT BRACKET INSTALLATION - CONTINUED

PARTS ARE PATENT PENDING. ALL RIGHTS RESERVED - COPYRIGHT ©2016 - ZROADZ LED, INC.



FIG 17



FIG 18



FIG 19

STEP 10

10) With the two brackets installed, check that the threads on the post after coming through the roof are clean.

STEP 11

SEE FIGURES 17 - 18

11) Install the split lock washer and the hex nut and tighten securely.

Check to make sure the upright is secured and firmly attached to top side of roof.



FIG 20

STEP 12

SEE FIGURE 20 - 22

12) Obtain the supplied security torx, lock washer and tool bit from the hardware pack. With a friend's help, install the 50" light to the brackets with the wire on the drivers side.

Tighten hardware by giving the torx bit some extra leverage.

STEPS 13

SEE FIGURE 23

13) Secure the wire to the driver bracket with supplied wire clip and nut. Leave slack in the wire from LED to the wire clip for some movement & available adjustment.

LED LIGHT INSTALL



FIG 21



FIG 22



FIG 23

LED LIGHT ROOF MOUNT INSTALLATION - CONTINUED



ZROADZ

DYNAMIC LED MOUNTING SOLUTIONS

LED LIGHT BRACKET INSTALLATION - CONTINUED

PARTS ARE PATENT PENDING. ALL RIGHTS RESERVED - COPYRIGHT ©2016 - ZROADZ LED, INC.



STEPS 14

SEE FIGURE 24

14) Cut the LED light wires. Leave enough room for the insulation to be removed and the red and black wires to pass through the roof via the "Through Bolt Down Tube".

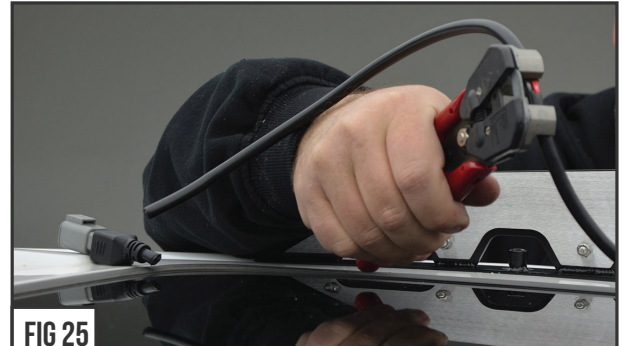

STEP 15

SEE FIGURE 25

15) Trim back a large amount of the insulation sheath off the LED Wires so that you can slip them through the rubber weather proofing boot.

To expose the wires, a sharp razor could easily splice open the insulation sheath.

WIRING PLUMBING



FIG 26

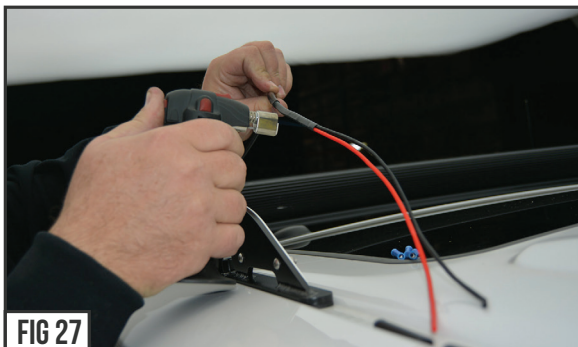

FIG 27

STEPS 16

SEE FIGURES 26 & 27

16) Install 1/4" heat shrink insulation over wires as shown in Figure #25. Shrink insulation with heat gun or similar.



FIG 28

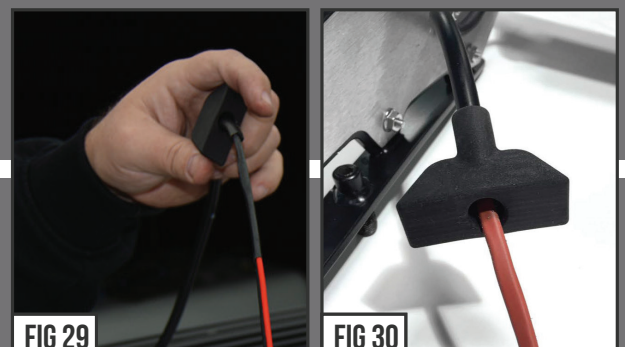

FIG 29



FIG 30

STEPS 17

SEE FIGURES 28 - 31

17) Use a 50/50 mix of dish soap and water solution to install supplied boot over wire as shown on page #2 Fig. 6.

Pass the wire through the tube. Use a liberal amount of solution on the bracket around the area where the boot installs to aid in slipping the boot over the post.



FIG 31

LED LIGHT BRACKET INSTALLATION - CONTINUED



ZROADZ

DYNAMIC LED MOUNTING SOLUTIONS

LED LIGHT BRACKET INSTALLATION - CONTINUED

PARTS ARE PATENT PENDING. ALL RIGHTS RESERVED - COPYRIGHT ©2016 - ZROADZ LED, INC.

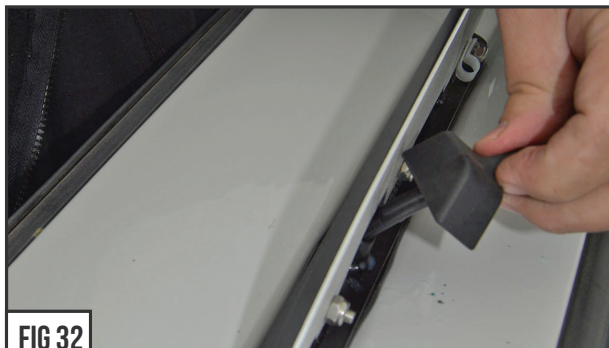

FIG 32



FIG 33

STEPS 18

SEE FIGURE 32

18) Stuff the boot into the bracket opening and over the down tube upright.

STEP 19

SEE FIGURE 33 - 36

19) With the rubber boot fully seated (as seen in Figures #33 & 34) you are now ready to finish wiring up the LED Light bar to a wiring harness.

After wiring is complete, re-install vehicle's interior in the reverse order it was removed according to industry "R&R" method.



FIG 34



FIG 35

STEP 20

20) Wire LED Light with a ZROADZ optional wiring harness kit (part# Z390020S-A) or by utilizing a compatible custom wiring harness. ZROADZ recommends LED Lights be wired with ZROADZ harness kit (part# Z390020S-A).

STEPS 18

ADJUSTMENT TIPS

21) To adjust the angle of your Light Bar, rotate the LED(s) to adjust the angles till your desired light pattern is reached. There will be minimal adjustment due to curved light bar orientation. You may then tighten the hardware and secure everything into place. Be careful not to over tighten the mounting hardware.

It is best to adjust the angle with the vehicle on level ground with lights facing a wall, garage door or other solid barrier. We recommend checking from a distance of 25'. Your installation is now completed.

FINAL INSTALLATION



FIG 36

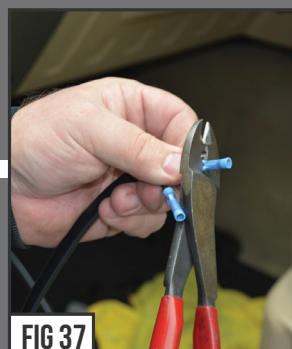

FIG 37

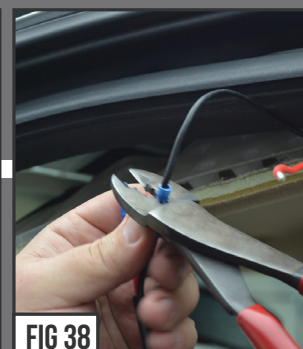

FIG 38



FIG 39

LED LIGHT ROOF MOUNT INSTALLATION - COMPLETE



ZROADZ

DYNAMIC LED MOUNTING SOLUTIONS

ZROADZ PRODUCT WARRANTY

ZROADZ PRODUCT WARRANTY

ZROADZ warrants its grille products to be free from defects in material and workmanship for the lifetime of the grille. ZROADZ warrants the finish of its grille products for a 3 year period beginning at the time of sale to the end user. These warranties are limited warranties and do not cover abuse, modification or improper installation nor do they cover finish failure caused by caustic cleaning agents, road salts or other chemicals. ZROADZ reserves the right to repair or replace a defective product at its sole discretion. Any ZROADZ product must be returned to ZROADZ for warranty consideration and must be returned at the customer's expense. In the event that the product is deemed to be defective, the repaired or replaced item will be returned via a surface shipping method to the customer at ZROADZ expense. No provision is made for any labor, rental car or other costs incurred by the failure of its products.

LED LIGHTING EQUIPMENT INSTALLATION / DISCLAIMER

WARNING

PLEASE CONSULT YOUR LOCAL AUTOMOTIVE ELECTRICAL PROFESSIONAL FOR INSTALLATION SERVICES AND ADVICE. ZROADZ IS ONLY EQUIPPED TO PROVIDE BASIC TECHNICAL ASSISTANCE DUE TO THE DIVERSITY OF VEHICLES, VEHICLE OPTIONS & MODIFICATIONS AND LIGHTING CONFIGURATION OPTIONS AVAILABLE. ZROADZ cannot be held liable due to improper component installation and / or faulty wiring.

GENERAL GUIDELINES

LED Lights & LED Light Bars operate at relatively high currents and should only be installed by qualified personnel with experience in switched / relayed high draw DC Circuits.

- Light Bars are designed for use only with standard 12v DC power systems
- Light Bars are for OFF-ROAD USE ONLY. Check your local laws & regulations regarding vehicle mounted lights.
- Some Light Bars are equipped with waterproof connectors while others are simply pig-tailed
- Red Wires = POSITIVE | Black Wires = NEGATIVE
- ALWAYS install your lights on a fused circuit. Basic fusing guidelines: maximum 5A for every 10" of LED Light Bar.

GENERAL USE, INSTALL AND ADJUSTMENT TIPS

NOTE 1: ZROADZ LED Light Bars themselves are for OFF-ROAD USE ONLY.

NOTE 2: Light Bars depending on the configuration of your vehicle and its options and/or modifications may need to be adjusted for appropriate beam projection. To adjust the angle of your light bars simply loosen the mounting hardware on either side of each Light Bar, rotate the Light Bar to adjust the angle, then tighten the hardware once the desired angle is achieved (please be careful not to over-tighten the mounting hardware or scratch the protective powder-coat finish). It is best to adjust the angle with the vehicle on level ground with the lights facing a wall, garage door or other solid barrier at a distance of approximately 25-30 feet.

NOTE 3: Please consult a qualified automotive electrical professional for light bar wiring installation.

NOTE 4: An optional universal wiring harness (part# Z390020S-A) is also available that includes high-heat & oil/fuel resistant wires, waterproof connector, 12v relay, 12v rocker switch, in line fuse holder. Our universal wiring harness significantly expedites the installation process but is not a vehicles specific "Plug & Play" product and does not eliminate the need for a professional installation.

Please contact your local ZROADZ dealer for more information or visit www.zroadz.com.

PRODUCT CARE INFORMATION

PRODUCT CARE INFORMATION

Wash regularly as you would when caring for your vehicles. Never use dish soap. Never leave wet water spots as that may leave a blemish.

MATTE BLACK FINISH

Paint warranty applies to defects in material and / or workmanship, it does not cover the matte finish surface appearance.

To enjoy the matte appearance for many years to come, please follow these owner care and maintenance tips.

Get a no-shine matte car wash soap that uses no fillers, no silicone, and won't strip your matte paint of its layer of protection.

Do not use wax, detail spray, armorall®, or any products made for normal paint. Use only products specifically developed for matte finish paint. Do not use products that are even mildly abrasive, such as polishes, glazes, or rubbing compounds. Do not use mechanical cleaners or polishers. Do not use terrycloth, cloth, or paper towels. Do not rub the finish vigorously, this will burnish the paint finish, causing a permanent shiny spot. Shiny spots cannot be removed.

Do not use commercial car wash facilities or their shine enhancement products. Most car wash brushes, large mechanized "towels," and shine enhancement products can damage matte paint.

Remove foreign substances such as insect remains, tar, and road debris using a soft applicator and a mild solvent; saturate and soak area before cleaning—rub lightly.

Hand-wash with a soft wash mitt and mild cleaning product safe for matte paint. Use microfiber cleaning cloths with alcohol-based window cleaner for basic surface clean-up.

GLOSS BLACK FINISH

ZROADZ with Gloss Black Powder Coated Finish may be washed regularly as you would when caring for your vehicles finish using soap and water. ZROADZ should be waxed at the same time that you wax the vehicle. As a general rule, anything you use to clean your vehicles painted surfaces can be used to clean and maintain your ZROADZ grille. A Gloss powder Coated Finish can be cared for in the same fashion that you would care for your vehicles factory paint job. Never leave wet water spots as that may leave a blemish.

PARTS ARE PATENT PENDING. ALL RIGHTS RESERVED - COPYRIGHT ©2019 - ZROADZ LED, INC.