

# S5016

03-07 CHEV/GMC 1500, 4.8L/5.3L,  
EXTENDED CAB/CREW CAB SHORT  
BOX, 2.5" DUAL REAR EXIT

# MBRP®

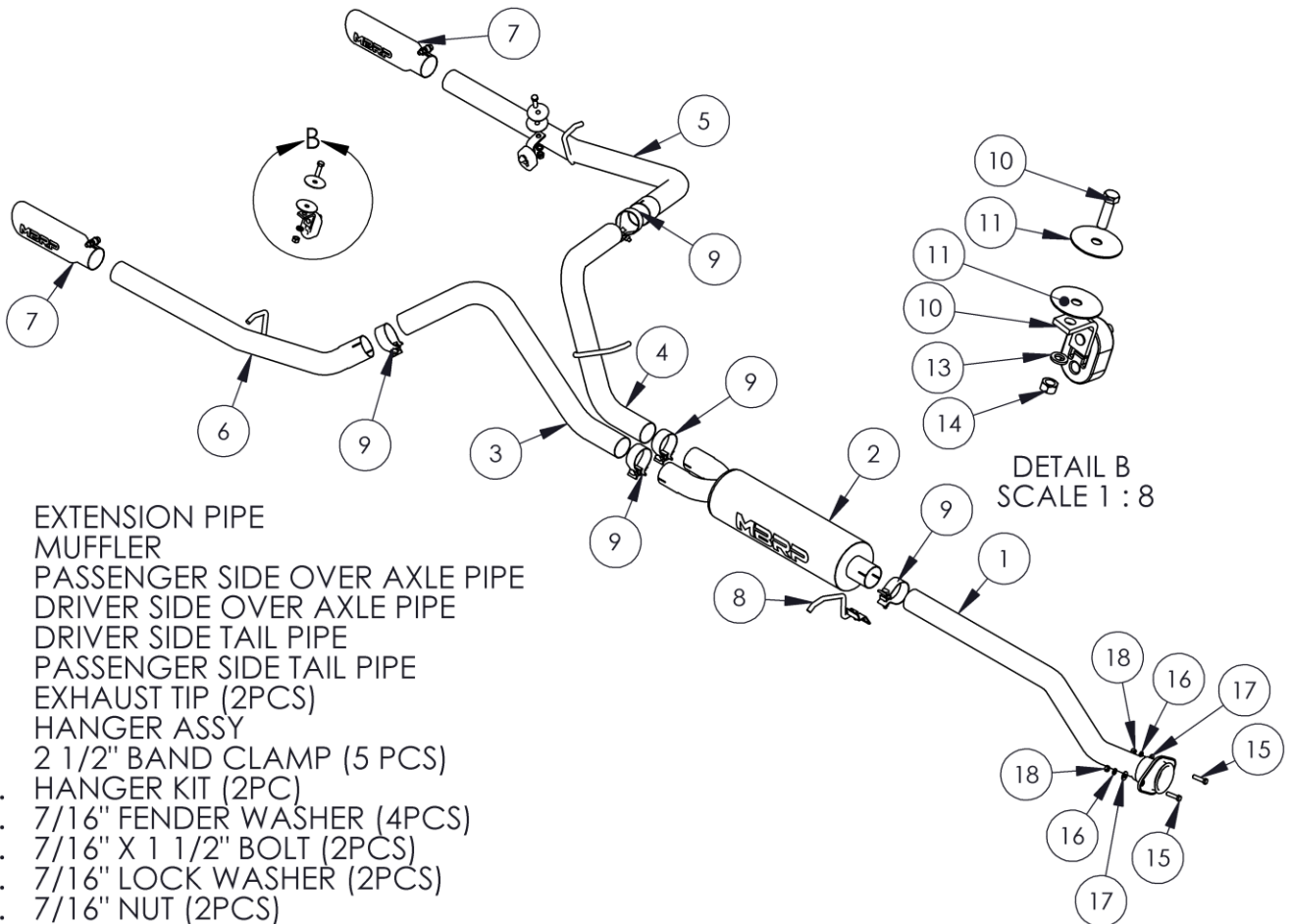

1. EXTENSION PIPE
2. MUFFLER
3. PASSENGER SIDE OVER AXLE PIPE
4. DRIVER SIDE OVER AXLE PIPE
5. DRIVER SIDE TAIL PIPE
6. PASSENGER SIDE TAIL PIPE
7. EXHAUST TIP (2PCS)
8. HANGER ASSY
9. 2 1/2" BAND CLAMP (5 PCS)
10. HANGER KIT (2PC)
11. 7/16" FENDER WASHER (4PCS)
12. 7/16" X 1 1/2" BOLT (2PCS)
13. 7/16" LOCK WASHER (2PCS)
14. 7/16" NUT (2PCS)
15. 3/8" X 1 1/2" BOLT (2PCS)
16. 3/8" LOCK WASHER (2PCS)
17. 3/8" WASHER FLAT (2PCS)
18. 3/8" NUT (2PCS)

DETAIL B  
SCALE 1 : 8

## PLEASE READ BEFORE STARTING INSTALLATION

**While MBRP Inc. has made every effort to ensure that all components of this system are of superior quality and properly packaged, it is the installer's responsibility to ensure the following before removal of the factory exhaust:**

- that ALL components shown above are present.
- that ALL mating components fit together.
- that there are no damaged components.
- that the system you have purchased is appropriate for your vehicle year, model and configuration.
- that the system will not interfere with any modifications previously installed or planned.
- that you have read and understand these instructions.

If you have any questions or are uncertain about any aspect of the installation of this system to your vehicle please contact your dealer before commencing installation.

# MBRP®



**Figure 1**



**Figure 2**



**Figure 3**



**Figure 4**



**Figure 5**

## Removal of Stock System:

1. Apply a penetrating lubricant liberally to all exhaust fasteners, hangers, and rubber insulators.
2. Remove the nuts from the studs holding the front flange together and disconnect exhaust system.
3. Remove the hangers from the rubber insulators and remove the exhaust from the vehicle. **Refer to Figure 1.** If a hoist or hydraulic lift is not being used the tail pipe may need to be cut to clear the rear axle.
4. The studs located in the exhaust flange must be removed. This can **be accomplished using a hammer.** The studs will be replaced by hardware supplied with the system. **Refer to Figure 2.**

## Installation of MBRP Inc. Performance Exhaust

1. Loosely attach the Extension Pipe at the flange using the hardware provided. **Refer to Figure 3.**
2. Loosely install the **Hanger Tight™ Clamp** around the front of the **Muffler** and into the factory rubber insulator located on the frame near the end of the **Extension Pipe.** **Refer to Figure 4.**
3. Install the **Hang Tight™ Hanger** onto a **2.5" Band Clamp** using the procedure shown below. (Hang Tight™ Hanger not exactly as shown)

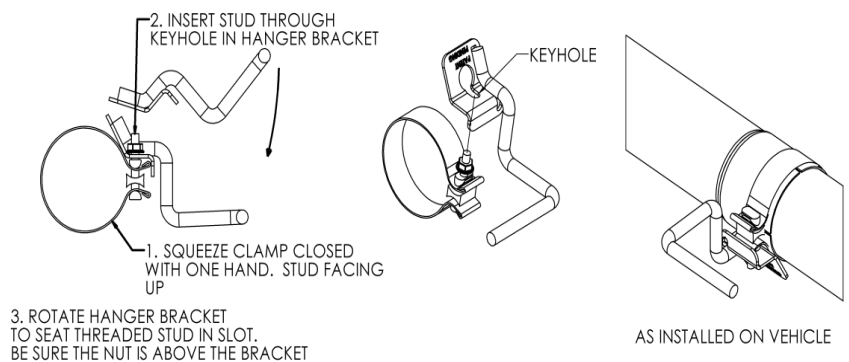

4. Install the **Muffler** onto the **Extension Pipe** with the outlets set horizontally. Loosely install the **Driver Side Over Axle Pipe** using a **2 ½" Clamp** to connecting it to the outlet closest to the drive shaft. Install the hanger into the rubber insulator located above the **Muffler** outlets. **Refer to Figure 6.**

# MBRP®



Figure 6



Figure 7



Figure 8



Figure 9



Figure 10

5. Feed the **Passenger Side Over Axle Pipe** over the axle and install it loosely into the left side of the **Muffler** using a **2 ½” Clamp**. Refer to **Figure 7**.
6. Feed the expanded end of the **Driver Side Tail Pipe** from the rear of the vehicle above the axle, around the outside of the shock absorber and connect it to the **Driver Side Over Axle Pipe** using a **2 ½” Clamp**. Refer to **Figure 9**.
7. Move the **Driver Side Tail Pipe** into approximate position. Using the factory hole in the frame located directly above the tail **Driver Side Tail Pipe** hanger, attach one of the **Hanger Assemblies** using the supplied hardware. Refer to **Figure 8 & 9**.
8. Feed the expanded end of the **Passenger Side Tail Pipe** from the rear of the vehicle over the axle and loosely connect it to the **Passenger Side Over Axle Pipe** using a **2 ½” Clamp**.
9. Move the **Passenger Side Tail Pipe** into approximate position. Using the factory hole provided in the frame located directly above the **Passenger Side Tail Pipe** hanger, attach the second **Hanger Assembly** provided using the supplied hardware.
10. Install and adjust the **Exhaust Tips** to suit. Using a 17mm wrench tighten the lock bolt located on each **Exhaust Tip**. Refer to **Figure 10**.
11. Tighten all hardware and clamps, starting at the front and working rearward to secure the system. Check along the full length of the exhaust system to ensure there is adequate clearance for fuel lines, vent lines, brake lines, frame, bodywork, suspension, and any wiring, etc. If there is any interference detected, relocate, or adjust to provide adequate clearance. Ensure all clamp connections are secure and components are unable to rotate or slide. Band clamps require approximately 45 lb-ft (60 N-m) of torque. Verify clearances, system security and band clamp torque after 30-60 miles (50-100 km) of driving.

**Congratulations!** You are ready to begin experiencing the driving pleasure of your MBRP Inc. performance exhaust system. We are confident that you will enjoy your purchase