



Installation Instructions

Replacement Fabric Soft Top for 1988-1995 Jeep® Wrangler YJ Vehicles Items #151101XX & #151111XX

*Color Spice shown
for illustration.*



Parts List:

Fabric Top - Qty 1
Quarter Window, Right - Qty 1
Quarter Window Left - Qty 1
Rear Window - Qty 1
Upper Door Skin, Right - Qty 1
Upper Door Skin, Left - Qty 1

Required Tools:

Safety Glasses
Shoe Horn Or Large Spoon
Razor Knife
Phillips Screw Driver
Large Beach Style Towel

⚠ WARNING ⚠

Loss of vehicle control involves risk of death or serious injury, particularly to parts of your body not restrained within vehicle. This product is intended for weather protection only and should not be relied upon to contain occupants in the event of an accident or to protect from either ground contact or falling objects. To reduce risk of accident or injury:

- ALWAYS WEAR SEATBELTS
- Always keep head, arms & body parts within vehicle.
- Fully secure or stow the soft top before driving according to instructions. Never try to latch or fold soft top while driving. Do not use if damaged or worn.
- Read and follow all instructions & warnings accompanying this product, in your vehicle owner's manual and Off Road Driving Supplement.

⚠ CAUTION ⚠

RISK OF EYE INJURY. Safety glasses should be worn at all times while installing or maintaining this product.



Important Safety information

Your MasterTop® Fabric Replacement Top is intended to be used with other MasterTop Products to increase the fair weather enjoyment of your off-road capable vehicle. Before installation, please take a moment to review the following safety information and installation instructions. Important safety information is generally preceded by one of three signal words indicating the relative risk of injury. The signal words mean:

⚠ WARNING ⚠

A hazardous situation which, if not avoided, could result in death or serious injury. You CAN be KILLED or SERIOUSLY HURT if you don't follow instructions.

⚠ CAUTION ⚠

A hazardous situation which, if not avoided, could result in minor or moderate injury. You CAN be moderately HURT and also may suffer property damage if you don't follow instructions.

NOTICE

Careful attention is required to this instruction or operation but does generally not relate to personal injury. Damage to your MasterTop product or other property may result if you don't follow instructions.

Before you begin Installation:

We are excited that you have chosen the MasterTop Fabric Replacement Soft Top. These quality tops are designed to enhance your driving pleasure while providing shade shelter from rain and wind. Though we have used only the finest materials in creating this top, any product that is exposed to the elements requires some general maintenance to keep it looking like new. Please see page 7 and insert sheet for these important maintenance tips. Please also note that it is normal for fabric to contract and wrinkle when stored in the shipping carton. In a few days the fabric will relax and wrinkles will disappear.

NOTICE

For a smooth fit and ease of installation, this top should be installed at temperatures above 72 degrees. Below this temperature, the fabric may contract an inch or more making it difficult to install. We highly recommend taking the top out of the package and letting it sit inside a warm place or direct sunlight for 1-2 hours before you install the top. When warm, this top will install quickly.

When unpacking, check to make sure all parts are included.

If any part is missing or broken, please call MasterTop customer service at 720-575-5440.

Installation of Fabric Replacement Top



Factory Hardware Requirement:

This product is designed to fit over your original factory soft top hardware and factory soft upper metal door frames. Please see Fig1 at left to make sure you have the correct hardware for this top. Note that on full hard door soft top models the hardware was different than the half hard door soft tops. This top is designed to fit over the original factory half door style soft top hardware only.

Please check to make sure your hardware looks like the picture to the left.



Step 1: Remove Existing Soft Top Fabric

Put on safety glasses. Remove your existing Soft top Fabric. Once the soft top is removed, inspect the hardware to make sure no parts are bent or missing. Once it is determined that the hardware is correct and not damaged, raise the bows (3/4 of the way up) and upper door surrounds and lock the door surrounds into place as shown in Figs 1 & 2. Make sure the rear spreader bars are not engaged at this time.



Installation of Fabric Replacement Top



NOTICE

Make sure your windshield channel is secured and not loose. The channel must maintain its 90 degree angle for it to work properly. Over time the windshield channel holes where the screws are located can rust out causing the channel to come loose. If this is the case you will need to replace your existing channel or replace existing screws with slightly larger screws. See additional photos WS1 and WS2 above.



Step 2: Position the Top on the Vehicle

Place the soft top fabric on the top of the hardware system.

The plastic header should be facing forward and the two rear corners should be facing down. See Fig 3.



Step 3: Attach New Fabric to Bows

Locate the front and rear snap straps and snap each to the front and rear bows securing the top to the hardware system. See Figs 4, 5, & 6.



NOTICE

If your original factory hardware has been replaced with an aftermarket version, the center snap strap will not be used. If this is the case, tuck the center snap strap under the top of the bows to keep it from hanging down.



Step 4: Install Top Fabric into the Windshield Channel

Insert the front plastic windshield retainer strip sewn along the front of the top into the Windshield Channel front slot. Do not catch any fabric in the channel. While installing, make sure the top is centered side to side in the channel so that there is an equal distance from the center of the windshield. See Figs 7 & 8



Installation of Fabric Replacement Top



Step 5: Secure the Front Bow Assembly

Push the front bow assembly all the way forward into the notch found on the side belt rail.

See Figs 9 & 10.



Step 6: Install Rear Corners

With the rear bow not completely engaged, install rear corners into the corner belt rails ensuring the clear/white plastic reinforcement are not hooked into the railing. Line up edge of the plastic strip with the edge of the retainer.

Repeat on other side.
See Fig 11.



Step 7: Secure the Rear Bows

Push the bottom of the rear bow back towards the rear of the vehicle until it snaps into place. Make sure the fabric rear corners are still engaged.

Note: the first time this is done it will be very tight.
See Figs 12 & 13.



Step 8: Lock Spreader Bars in Place

With the rear bows secured, push up on the spreader bars until they lock into place. Make sure when pushing up on the spreader bars that you go straight up and not up and "inwards" while pushing. Pushing inwards will damage your spreader bars.

See Figs 14 & 15.



Step 9: Install Side Curtains

Release the spreader bars. Line up and attach the top and side zippers on the side curtains approximately 2-3 inches. Note that the side zipper may not line up with the corner fabric unless you slide the corner fabric around in the belt rail towards the front of the vehicle. Once the side zipper is attached and zipped up 2-3 inches, you can slide the corner back around towards the rear of the vehicle and line up the black plastic strip with the edge of the retainer. See step 10 (next page) and see Figs 16 & 17.

Installation of Fabric Replacement Top



Step 10: Insert Side Curtains into Vertical Door Surround Retainer

With the top and side zippers still only partially closed 2-3", slip the plastic strip on the front of the side curtain into the retainer channel on the vertical support bow. See Fig 18.



Step 11: Attach Side Curtains to Body Belt Rail

While pulling down, slip the side curtain bottom retaining channel into the body belt rail starting from one end and pressing down to the other as shown in Figs 19 & 20.



Completely zip up side curtain Zippers, re-engage spreader bars and then completely zip top side curtain zipper. See Fig 21. Repeat steps nine through eleven on the other side of the vehicle.



Step 12: Install the Rear Curtain

Attach the Top Zipper on the rear curtain to the top.

Zip across 3-6" only. Attach both side zippers on the rear curtain to the top zipping them down about 3-6".

See Figs 22 & 23.

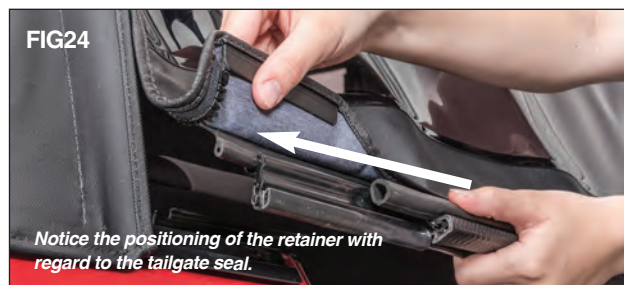

Step 13: Install Tailgate Retainer

With the rear curtain loosely installed, open the tail gate and slide the rear curtain retainer onto the bottom of the rear curtain. See Fig 24.



Installation of Fabric Replacement Top



Step 14: Securing the Rear Tailgate Retainer

With the rear curtain attached, “roll” the rear tailgate bar into the two rear tailgate retainers.

Once engaged into the retainers, slip the rear curtain plastic retainers into the bottom of the tailgate retainer channel. See Figs 25, 26 & 27.

Zip the rear curtain top and two side zippers closed.



Step 15: Snap Top Over Door Snaps

Fasten snaps on top to the over door sliding studs on hardware. Snaps should easily slide to match snap locations on the top. See Fig 28.

The Soft top portion of the installation is now complete.

⚠ WARNING ⚠ When using a razor knife, be sure to keep hands, fingers and other body parts safely away from the knife blade. Use extreme caution as serious injury can occur.

Step 16: Remove Old Upper Door Skins

Remove the upper door fabric from the door frames. Use a razor knife to carefully cut the stitches on the upper door frame fabric and remove them from the metal door frame. See important warning at left.

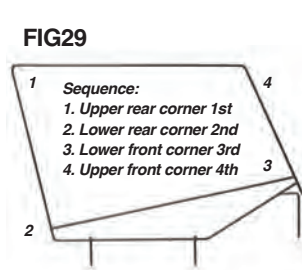

Step 17: Install New Upper Door Fabric over Door Frames

Lay a large towel on the ground and place the upper door skin on the towel to prevent scratching. Un-zip the door skin window and un-due all hook and loop fasteners on the door skin. **IMPORTANT:** See Fig 29 for the installation sequence on installing the door skin to the door frame. Place the metal frame gently into the top upper rear corner “pocket”. See fig 30.

NOTICE Door Covers are designed to fit very tight on the door frames. We highly recommend having an extra set of hands to install these door skins. In some cases a shoe horn or large spoon can be used to help work the corners of the covers over the frames without tearing the fabric. **DO NOT** pull on the weather strip when installing the door skins to the door frames.



Installation of Upper Door Fabric



Step 18: Install New Upper Door Fabric over Door Frames (continued)

Start by working the upper rear corner of the door frame into the pocket of the cover. Then work the lower rear corner of the frame into the cover. Work the bottom front corner of the frame into the cover.

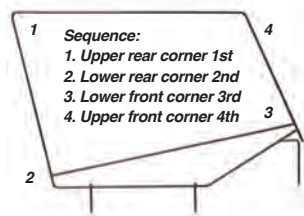

NOTE: the frame should fit in-between the hook and loop flaps, not between the zipper and the flaps.

Lastly, work the upper front corner of the frame into the corner of the door cover. See Figs 31, 32 & 33



Step 19: Install New Upper Door Fabric over Door Frames (continued)

With all four corners inserted into the fabric pockets, secure the final hook and loop strip above the door pins. Note that this will take some pulling and will over time loosen up making it easier to install. Repeat all steps for the opposite side door.

See Figs 34 & 35

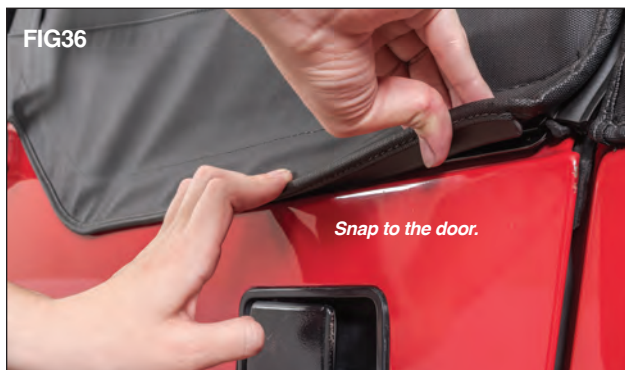

Step 20: Install Your Upper Doors to Hard Half Doors

Install upper doors to hard half doors. Insert the pins into the door grommets in the lower hard half doors. Note that for the doors to work properly the door grommets must be un-damaged and in place. Snap the front snap on the front of the door to the snap stud on the hard half door. Work the plastic retaining strip into the door rail to secure the upper door to the hard half door. See Fig 37.

The Complete Fabric Replacement Soft top installation is now complete.

Care and Maintenance of your MasterTop® Product:

Your MasterTop Replacement Top is made of the finest materials available but to keep it looking new and for the maximum possible wear, it will need periodic cleaning and basic maintenance. The main threat to your soft top is pollutants, dirt and grime. Please see separate sheet for care and maintenance recommendations.

For more information on MasterTop: Helpful product information is available on www.mastertop.com Please visit our website frequently for product updates and exciting news.





Limited 3 Year Warranty

Your MasterTop® accessory is covered by the following Limited Warranty provided exclusively by MasterTop, Inc., 420 J Corporate Circle, Golden, CO 80401.

This Limited Warranty is the only warranty made in connection with your purchase. MasterTop neither assumes nor authorizes any vendor, retailer or other person or entity to assume for it any other obligation or liability in connection with this product or Limited Warranty. This Limited Warranty does not apply and is not cumulative to any accessory or part distributed by any MasterTop distributor for which the Manufacturer provides a separate written warranty.

What is Covered: Subject to the terms, exclusions and limitations herein and with respect only to MasterTop branded accessories first sold in the United States, MasterTop warrants to the initial retail purchaser only that your MasterTop accessory shall be free of defects in material and workmanship; **for a period of 3 years from date of initial retail sale.**

All other warranties are hereby disclaimed, except to the extent prohibited by applicable law in which case any implied warranty of merchantability or fitness for a particular purpose on this product is **limited to 3 years from date of initial retail sale.** MasterTop reserves the rights to: (a.) require invoice or other proof your product is within the terms of this Limited Warranty as a condition of warranty service and, (b.) make future revisions to this product and Limited Warranty without prior notice or obligation to upgrade your product.

What is Not Covered: Your MasterTop Limited Warranty does not cover products or parts MasterTop determines to have been damaged by or subjected to: (a.) installation damage, alteration, modification, failure to maintain or attempted repair or service by anyone not authorized by MasterTop, (b.) normal wear and tear, cosmetic damage or damage from water immersion, (c.) Acts of God, accidents, misuse, negligence, inadequate mounting or impact with vehicle(s), obstacles or other aspects of the environment, (d.) theft, vandalism or other intentional damage, (e.) fleet, rental or commercial use, (f.) use in competition or racing.

Remedy Limited to Repair/Replacement: The exclusive remedy provided hereunder shall, upon MasterTop inspection and at MasterTop's option, be either repair or replacement of product or parts (new or refurbished) covered under this Limited Warranty. Customers requesting warranty consideration on MasterTop Products should first contact MasterTop to obtain a RGA number (720-575-5440). All labor, removal, shipping and installation costs are customer's responsibility.

Other Limitations - Exclusion of Damages - Your Rights Under State Law:

In consideration of the purchase price paid, neither MasterTop nor any independent MasterTop distributor /licensee are responsible for any time loss, rental costs, or for any incidental, consequential, punitive or other damages you may have or incur in connection with any part or product purchased. Your exclusive remedy hereunder for covered parts is repair/replacement as described above.

This Limited Warranty gives you specific rights. You may also have other rights that vary from state to state. For example, some states do not allow limitations of how long an implied warranty lasts and/or do not allow the exclusion or limitation of incidental or consequential damages, so the limitations and exclusions herein may not apply to you.

©MasterTop, Inc. 2018. All Rights Reserved. The term MasterTop® is a Registered Trademark of MasterTop Incorporated, Registered in U.S. Patent and Trademark Office.

www.MasterTop.com

Part #941020.01 Version 3.23.18 LTR





Care Instructions Sheet

Care and Maintenance of your MasterTop® Product:

Your MasterTop Replacement Top is made of the finest materials available but to keep it looking new and for the maximum possible wear, it will need periodic cleaning and basic maintenance. The main threat to your soft top is pollutants, dirt and grime. By keeping your top clean you will prolong the life of your top.

We recommend the following to keep your top like new:

Washing:

The soft top fabric should be washed often using a mild soap, warm water and a soft bristle brush. You can also use special soft top cleaners available on our Distributors websites. Make sure that after cleaning you rinse with clear water to remove all traces of soap to avoid residue.

Water/Fabric:

In the event of seeping through the seams, 3M Scotchgard® may be applied on the inside of the seams to stop the seeping. Rips in the fabric may be repaired with Bondex® iron on patches. Iron the patches to the Inside of the top, carefully following the Bondex® instructions.

Windows:

It is very important that you keep your Soft Top windows clean! Use a mild soap and water solution to gently clean your windows. NEVER wipe your windows clean with a dry cloth! Dust and dirt on a dry cloth can scratch your windows causing “fogging” and permanent damage. When removing your windows, store them with a towel. If frost or ice forms on the outside of your windows during the winter, DO NOT use an ice scraper to remove this frost. Over time you will see small micro scratches in your windows which are natural wear and tear. These Micro scratches can be “polished” out using the window polish available at your MasterTop Distributor.

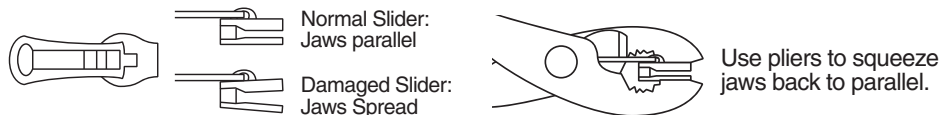

Zippers:

Keeping the zipper cleaned and lubricated with a silicone lubricant (available online) will help prevent damage and keep the zippers in a smooth working condition. If zipper opens behind the slider, the slider may have been spread apart. This problem can usually be fixed by using an ordinary pair of pliers to bring the sides back into parallel. Return slider to the end of the zipper in the normal Open position. Squeeze lightly at first and test zipper. If the zipper continues to remain open squeeze more firmly with pliers and try the zipper again. Repeat procedure until your zipper operates correctly.

For more information on MasterTop:

This and other helpful product information is available on www.mastertop.com
Please visit our website frequently for product updates and exciting news.

©MasterTop, Inc. 2018. All Rights Reserved. The term MasterTop® is a Registered Trademark of MasterTop Incorporated, Registered in U.S. Patent and Trademark Office.

www.MasterTop.com

