



Installation Instructions

**Bimini Top Plus & Wind Stopper Combo for
2020-Current Jeep® Gladiator Vehicles**
Items #143007XX, 148507XX



Bimini Top Plus Parts List:
Fabric Bimini Top Plus - QTY 1
Wind Stopper -QTY 1*
*(148507xx models only)

Required Tools:
Safety Glasses
T25 Torx Bit & Driver
*(Found in on-board tool kit)

Loss of vehicle control involves risk of death or serious injury, particularly to parts of your body not restrained within vehicle. This product is intended for weather protection only and should not be relied upon to contain occupants in the event of an accident or to protect from either ground contact or falling objects. To reduce risk of accident or injury:

• ALWAYS WEAR SEATBELTS

WARNING

- Always keep head, arms & body parts within vehicle.
- Fully secure or stow the soft top before driving according to instructions. Never try to latch or fold soft top while driving. Do not use if damaged or worn.
- Read and follow all instructions & warnings accompanying this product, in your vehicle owner's manual and Off- Road Driving Supplement.

CAUTION

RISK OF EYE INJURY. Safety glasses should be worn at all times while installing or maintaining this product.



Important Safety information

Your MasterTop® Bimini Top Plus and Wind Stopper are intended to increase the fair weather enjoyment of your off-road capable vehicle. Before installation, please take a moment to review the following safety information and installation instructions. Important safety information is generally preceded by one of three signal words indicating the relative risk of injury. The signal words mean:

WARNING

A hazardous situation which, if not avoided, could result in death or serious injury. You CAN be KILLED or SERIOUSLY HURT if you don't follow instructions.

CAUTION

A hazardous situation which, if not avoided, could result in minor or moderate injury.

You CAN be moderately HURT and also may suffer property damage if you don't follow instructions.

NOTICE

Careful attention is required to this instruction or operation but does generally not relate to personal injury. Damage to your MasterTop product or other property may result if you don't follow instructions.

Before you begin Installation:

We are excited that you have chosen the MasterTop Bimini Top Plus and/or Wind Stopper! These high-quality tops are designed to enhance your fair-weather driving pleasure while providing needed shade while driving in the hot sun. Please note that it is important that you become familiar with the installation process of this top by reading the following instruction sheet and warnings thoroughly. Though we use only the finest materials in creating this top, any product that is exposed to the elements requires some general maintenance to keep it looking like new. Please see page 7 for these important maintenance tips. Please also note that it is normal for the vinyl fabric to contract and wrinkle when stored in the shipping carton. In a few days the fabric will relax and wrinkles will disappear.

NOTICE

For a smooth fit and ease of installation, this top should be installed at temperatures above 72 degrees. Below this temperature, the fabric may contract an inch or more making it difficult to install. We highly recommend taking the top out of the package and letting it sit inside a warm place or direct sunlight for 1-2 hours before you install the top. When warm, this top will install quickly.

When unpacking, check to make sure all parts are included.

If any part is missing or broken, please call MasterTop customer service at 720-575-5440.

Pre-Installation of Bimini Top:



Threading Straps through Buckles:

Throughout the installation, you will need to thread webbing straps through buckles several times. Please review the picture for correct strap routing through the buckles. As a rule of thumb, run the strap below and through the sewn side of the buckle first and then back down through the end of the buckle. Tighten the strap by simply pulling the exposed webbing after threading the strap through the buckle.



Windshield Seal Information:

Your MasterTop Bimini Plus has a reinforced rubber seal that is sewn into the front edge of the top to help block water and debris from entering the cab.

This seal must be tucked into the gap between the windshield and the roll bar as shown above to help prevent water from entering the cab. This seal does not make this top water tight!

See the notice below:

NOTICE

Though this top is made of waterproof materials, it is not waterproof. Water can enter the cab in-between the doors and the roll bar as well as possible leakage around the front rubber seal near the windshield. This top must be removed when putting your soft or hard top back on your vehicle.



Installation Instructions 3

Installation of Bimini Top Plus

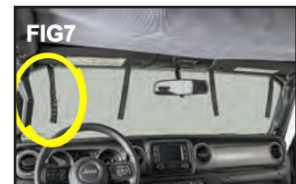

Step 1: Drape Fabric and Install Front Side Straps

Put on safety glasses. After removing your hard top or soft top from your vehicle, Drape the Bimini Top Plus fabric over the top of the vehicle with the front rubber seal facing forward. The top should rest on the roll bar structure. With the front doors open, locate the three straps on each side shown in FIG1.

Loosely wrap these straps on the side horizontal tubes, thread the straps through the buckle and loosely tighten. Repeat on the other side FIGS 2 & 3. This will help hold up the front portion of the top while you thread the front straps through the Windshield and roll bar in step two. You will tighten these straps later in the install.

Step 2: Thread Front Corner Straps

Standing on the threshold of your Jeep, locate the front corner strap on the driver's side and thread the strap between the windshield and the front roll bar sliding it slightly from left to right until it works its way through the gap. See FIGS 4, 5 & 6.

Note that before you thread the strap, run your fingers over the front of the strap so it curls downward. This will make it easier to thread.

The strap will come through in front of your windshield as circled in FIG 7.

Step 3: Attach Front Corner Straps

Once threaded through the windshield and roll bar, locate the front buckle (FIG 8) and secure the front strap to the buckle as shown in FIGS 9, 10 & 10A.

Repeat Steps 2 and 3 on the passenger side.



Installation of Bimini Top:



Step 4: Thread the Four Front Center Straps

As you did in step 2, stand on the threshold of your Jeep, locate the four center straps and thread the straps between the windshield and the front roll bar sliding it slightly from left to right until it works its way through the gap.

Note that before you thread the strap, run your fingers over the front of the strap so it curls downward. This will make it easier to thread.



The four straps will come through in front of your windshield as shown in Fig 13.

Thread the Straps through the Front Trim: Once the front straps are threaded through the windshield, you will need to also thread them behind and through the front trim piece as shown in Figs 14 & 15. Once threaded through, you now have all four straps coming through from behind the trim: two straps on each side of the sun visors.



Step 5: Attach the Front Center Straps

Locate the two center front straps.

On the front of the windshield there are two Freedom panel locator brackets, one on each side of the rear-view mirror (FIG 16).

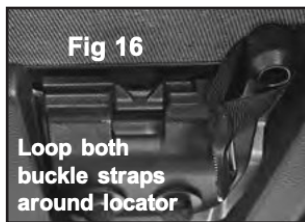

Loop the two buckled end loops of the center front straps around this locator bracket (FIG 16) and thread the two center straps through the buckles securing the center straps to the locator brackets (Fig 17).

Tighten all front straps buckled in steps 2 through 5 pulling the top tight across and forward. It is VERY important that these straps are extremely tight before you attach any of the rear straps.



Notice in FIG 18 and 18A how the front rubber seal should fit under the windshield.



Installation of Bimini Top:



Step 6: Attach the Two Front B-Pillar Straps

With the back of the top resting on the rear roll bar, locate the B-Pillar straps located just behind the front door (FIGs 19 & 20).

With the rear door open, wrap the strap down and around the inside of the B-Pillar and attach the strap to the buckle as shown (FIGs 20 & 21).



Repeat on the other side of the vehicle. Tighten these straps.

Step 7: Attach the Two Center Rear Straps

Locate the two Center rear straps as circled in FIG 22. Wrap the straps around the roll bar and attach it to the buckles installed on the top. Repeat on the other side and tighten these straps starting on one side and then to the other to ensure the top is centered.



Step 8: Attach the Back Two Rear Corner Straps

Locate the rear corner strap as shown in Fig 23. These straps will go around the roll bar and attach back to a factory mounting point on the lower portion of the roll bar (FIG 24). Using a T25 Torx Driver and bit (found on the on-board tool kit) remove the original screw, slip the screw through the Buckle strap and re-attach the screw (Fig 24, 25, 26 & 27). Pull the rear corner strap up and around the inside of the roll bar (Fig 28) and attach the strap to the buckle (Fig 29). Repeat on other side and cinch these corner straps tight. Cinch all straps on the top to take out any wrinkles and to prevent flapping.



Tuck any extra strap material under the installed straps to keep them out of the way.



Your Bimini Top Plus is now Installed



Installation of the Optional Gladiator Wind Stopper:

The MasterTop Wind Stopper is designed to work in tandem with the Bimini Top Plus. For the Wind Stopper to attach correctly to the Bimini Top Plus, you must buy these two components as the kit part# 148507XX. The Bimini Top Plus included in this kit has a strip of hook and loop fastener attached to the rear of the Bimini Top Plus:



The Wind Stopper straps are designed to fit over the Bimini Top Plus straps as shown above. The rear window can be un-zipped and folded down.

Step 1: Attach the Wind Stopper to the Roll Bar

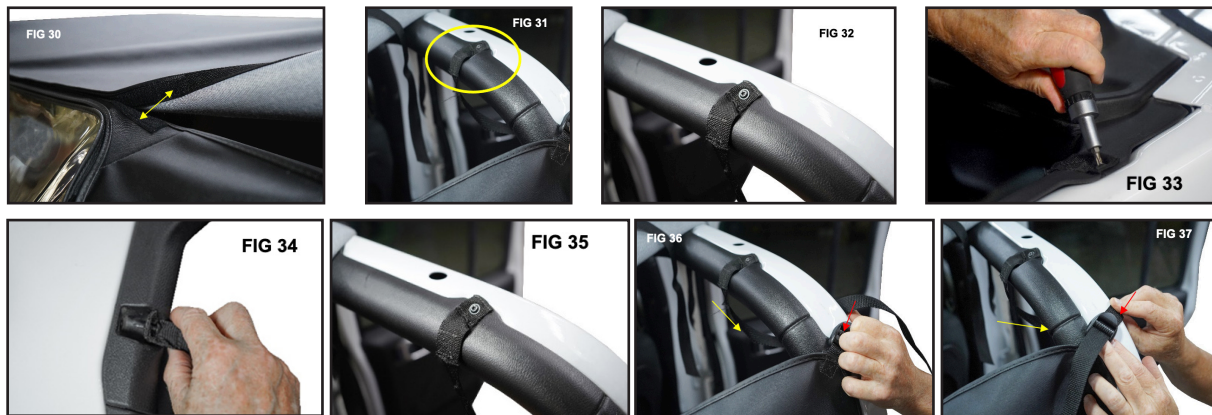

For ease of install, find the center of the Wind Stopper and attach it to the center of the Bimini Plus hook and loop strip. Keep the edges of the hook and loop un-hooked. This will hold the Wind Stopper up while you attach the side straps (FIG 30).

Locate the factory mounting point circled in FIG 31. As you did in step 8 of the Bimini Plus install, remove the factory Torx head screw with the T25 driver and bit, place the screw through the corner strap and secure the screw back in the roll bar (FIG's 33, 34 & 35). Wrap the secured strap under the roll bar and back around as shown in FIG 36. Attach the strap to the buckle (FIG 37). Repeat this on the other side securing the Wind Stopper in place.



Step 2: Attach the Wind Stopper to the side of the Roll Bar



With the Wind Stopper secured at the top two corners, locate the two side straps as shown in FIG 38. Attach these straps around the Roll Bar and loosely tighten (FIG's 39 & 40). Repeat on the other side tightening the straps from one side to the other to make sure the Wind Stopper is centered.

Step 2: Attach the Wind Stopper to the Truck Bed

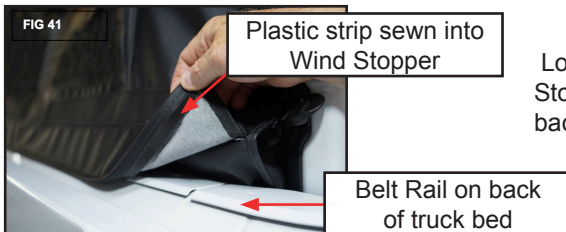

Locate the plastic strip sewn into the bottom of the Wind Stopper. This strip will be inserted into the "lip" located on the back of the truck bed. This "lip" is called a belt rail (FIG 41).



Attach the top Hook and Loop strip all the way across the back of the Bimini Plus securing the Wind Stopper to the Bimini Plus. Slip the Plastic strip into the belt rail all the way across the back of the truck bed (FIG 42). Once inserted, tighten all side and top straps while making sure the Wind Stopper is centered between the roll bars.

The Wind Stopper and Bimini Plus Combo is now installed.

Care and Maintenance of your MasterTop ShadeMaker™ Bimini Plus Top:

Your MasterTop ShadeMaker Bimini Top or Bimini Top Plus is made of the finest materials available but to keep it looking new and for the maximum possible wear, it will need periodic cleaning and basic maintenance. The main threat to your soft top is pollutants, dirt and grime. By keeping your top clean you will prolong the life of your top.

We recommend the following to keep your top like new:

Washing:

The top fabric should be washed often using a mild soap, warm water and a soft bristle brush. You can also use special soft top cleaners available on our Distributors websites. Make sure that after cleaning you rinse with clear water to remove all traces of soap to avoid residue. Hang to dry, do not put a Top in a clothes dryer.

For more information on MasterTop:

This and other helpful product information is available on www.mastertop.com Please visit our website frequently for product updates and exciting news.





Limited 3 Year Warranty

Your MasterTop accessory is covered by the following Limited Warranty provided exclusively by MasterTop, Inc., 420 J Corporate Circle, Golden, CO 80401.

This Limited Warranty is the only warranty made in connection with your purchase. MasterTop neither assumes nor authorizes any vendor, retailer or other person or entity to assume for it any other obligation or liability in connection with this product or Limited Warranty. This Limited Warranty does not apply and is not cumulative to any accessory or part distributed by any MasterTop distributor for which the Manufacturer provides a separate written warranty.

What is Covered: Subject to the terms, exclusions and limitations herein and with respect only to MasterTop branded accessories first sold in the United States, MasterTop warrants to the initial retail purchaser only that your MasterTop accessory shall be free of defects in material and workmanship; for a period of 3 years from date of initial retail sale.

All other warranties are hereby disclaimed, except to the extent prohibited by applicable law in which case any implied warranty of merchantability or fitness for a particular purpose on this product is limited to 3 years from date of initial retail sale. MasterTop reserves the rights to: (a.) require invoice or other proof your product is within the terms of this Limited Warranty as a condition of warranty service and, (b.) make future revisions to this product and Limited Warranty without prior notice or obligation to upgrade your product.

What is Not Covered: Your MasterTop Limited Warranty does not cover products or parts MasterTop determines to have been damaged by or subjected to: (a. installation damage, alteration, modification, failure to maintain or attempted repair or service by anyone not authorized by MasterTop, (b.) normal wear and tear, cosmetic damage or damage from water immersion, (c.) Acts of God, accidents, misuse, negligence, inadequate mounting or impact with vehicle(s), obstacles or other aspects of the environment, (d.) theft, vandalism or other intentional damage, (e.) fleet, rental or commercial use, (f.) use in competition or racing.

Remedy Limited to Repair/Replacement: The exclusive remedy provided hereunder shall, upon MasterTop inspection and at MasterTop's option, be either repair or replacement of product or parts (new or refurbished) covered under this Limited Warranty. Customers requesting warranty consideration on MasterTop Products should first contact MasterTop to obtain a RGA number (720-575-5440. All labor, removal, shipping and installation costs are customer's responsibility.

Other Limitations - Exclusion of Damages - Your Rights Under State Law:

In consideration of the purchase price paid, neither MasterTop nor any independent MasterTop distributor /licensee are responsible for any time loss, rental costs, or for any incidental, consequential, punitive or other damages you may have or incur in connection with any part or product purchased. Your exclusive remedy hereunder for covered parts is repair/replacement as described above.

This Limited Warranty gives you specific rights. You may also have other rights that vary from state to state. For example, some states do not allow limitations of how long an implied warranty lasts and/or do not allow the exclusion or limitation of incidental or consequential damages, so the limitations and exclusions herein may not apply to you.

©MasterTop, Inc. 2020. All Rights Reserved.
The term MasterTop is Trademark of MasterTop Inc.

www.MasterTop.com

Part #941051.01 Version 12.14.20

